

# TESA UNIMASTER Universal Measuring Instrument

Provides the features necessary for direct measurement of specially large internal and external dimensions.

TESA UNIMASTER is similar to internal micrometers with two-point contact with the workpiece being measured. Measures any dimension within the extended application range directly by simply adding the needed extensions with built-in gauge blocks to the measuring element.

Accurate, robust and easy-to-handle – Can be used either vertically or horizontally with a constant measuring force – Incorporates a lever-type dial test indicator that clearly shows the culmination point – Ensures stable measuring owing to both a negligible deflection and thermal protection on each extension.

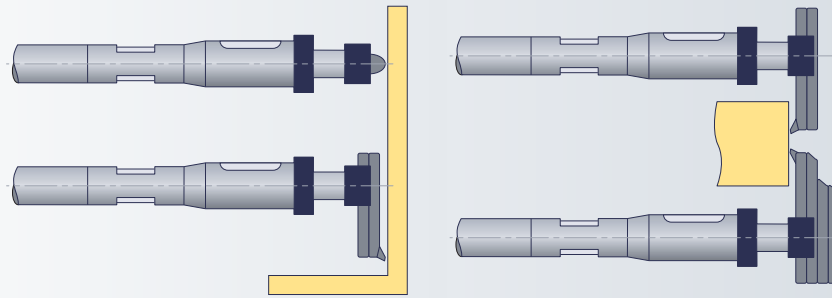

DIN 863 T4  
(Style B)

**Measuring element**

Micrometer and dial test indicator: 0,01 mm

Micrometer: 25 mm

1 mm

Dial test indicator: ± 0,4 mm

15 to 20 N. Mobile ball-bearing anvil under spring pressure.

Reversible probing direction to allow both internal and external measuring.

5 µm

**Measuring bolts**

Tungsten carbide tipped

Measuring bolts supplied in pairs:

- No. 01110203 for internal measuring in the micrometer axis.
- No. 01110205 for internal/external measuring, meas. depth up to 60 mm from the lower edge of the micrometer.
- No. 01110208, extra-rigid for external measuring, meas. depth up to 75 mm from the lower edge of the micrometer.

**Extensions**

38 mm dia. diameter steel tube with snap ring system. Built-in gauge rod.

Tungsten carbide tipped

One spherical and one flat measuring faces



**Additional Data**

Wooden case

Measuring element and setting standard with identification number

Declaration of conformity



mm

TESA UNIMASTER complete set



mm

**01110000**

Internal dim. 250 ÷ 1475\*  
External dim. 225 ÷ 1450\*

Consisting of:



mm

mm

µm

**01110300**

Measuring element

internal dim. 250 ÷ 275  
external dim. 225 ÷ 250

**01110203**

Pair of measuring bolts for internal measuring

**01110205**

Pair of measuring bolts for internal/external measuring, with length to 75

**01110208**

Pair of measuring bolts for extern. measuring, length 100

**01110501**

Setting standard internal dimension 250  
external dimension 225

**01110101**

Extension 25 0,7

**01110102**

Extension 50 1

**01110103**

Extension 75 1,2

**01110104**

Extension 100 1,5

**01110105**

Extension 125 1,5

**01110106**

Extension 150 2

**01110112**

Extension 300 3,5

**01110118**

Extension 450 4,5

**01110124**

Extension 600 6,5

**01130001**

Special screwdriver for extensions

**01110401**

Set of suspension accessories (4 brackets together with 4 clamps)

**01112401**

Wooden case for complete set

*Optional Accessories*

**01110140**

Extension 1000 10

**01162001**

Pair of measuring bolts for internal/external dimensions and grooves Measuring depth ≤ 20  
Tungsten carbide inserts Ø 4 x 7

**01160001**

Support roller supplied individually (2 items are needed)

\* Using 3 extensions at the very most.

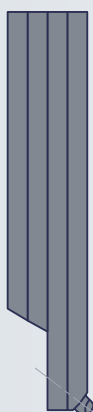

01110208



01110205



01110203

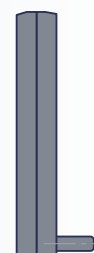

01162001

