



EN ISO 463
Factory standard

0,01 mm

2,2 mm

Rotating dial.
Regular models
with dial lock.

Full-metal
case housing.
Fixing shank and
plunger in hardened stainless
steel.

High performance
shock proof system
in both directions

Adjustable
tolerance markers.
Insert with
M2,5 thread

3 mm dia.
ball tip, already
mounted.

Cardboard box

Identification
number

Inspection report
with a declaration
of conformity

TESA YR and MERCER Precision Dial Gauges – TOP Quality

These **TOP Quality** precision dial gauges combine excellent metrological properties with extra-long life.

- Smooth, full-jewelled movement with rubies.
- Full-metal bezel and case housing.
- Shock proof mechanism effective in the two directions towards the plunger moves.
- Non-dazzling dial.
- Swiss Made.

TESA YR – TOP Quality 40 mm dial diameter, 0,01 mm reading

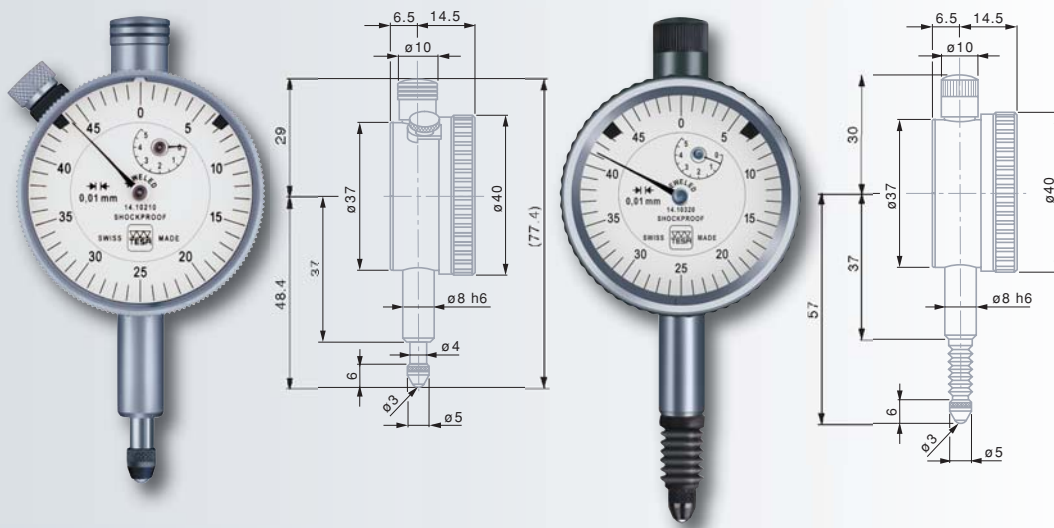

TOP Quality line

01410210	0,01	5	5,4	●	0,5	0 ÷ 25 ÷ 50	●
01410211	0,01	5	5,4	●	0,5	0 ÷ 25 ÷ 0	●
01410212	0,01	5	5,4	●	0,5	0 ÷ 25 ÷ 50	–

TOP Quality line IP54 protected against the penetration of liquids

01410320	0,01	5	5,4	●	0,5	0 ÷ 25 ÷ 50	–
01410321	0,01	5	5,4	●	0,5	0 ÷ 25 ÷ 0	–

Permissible limits of a metrological characteristic (MPE/MPL)

		0,01 mm
	Deviation span	12 µm
	Deviation span within the local measuring span 0,10 mm	6 µm
	Total deviation span	14 µm
	Repeatability limit	3 µm
	Max. hysteresis	3 µm
	Measuring force	TOP Quality line
		TOP Quality line IP54
		≤ 1,4 N
		≤ 2 N

TESA YR and MERCER Dial Gauges – TOP Quality 40 mm dial diameter, 0,001 or 0,002 mm reading



- ✓
- EN ISO 463
Factory standard
- 0,001 mm
0,002 mm
- 1,1 mm
- Rotating dial.
Regular models with dial lock
- Full-metal case housing.
Fixing shank and plunger in hardened stainless steel
- High performance shock proof system in both directions
- Adjustable tolerance markers
Measuring insert with M2,5 thread.
- 3 mm dia. ball tip, already mounted.
- Cardboard box
- Identification number
- Inspection report with a declaration of conformity

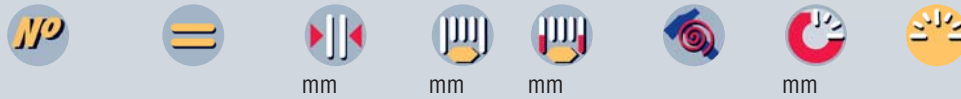

TOP Quality line, with dial lock

01410010		0,001	1	1,5	●	0,1	0 ÷ 50 ÷ 100
01410011		0,001	1	1,5	●	0,1	0 ÷ 50 ÷ 0
01416007	195-1TQ	0,002	3	3,3	●	0,2	0 ÷ 10 ÷ 0

TOP Quality line IP54 protected against the penetration of liquids, without dial lock

01410120		0,001	1	1,5	●	0,1	0 ÷ 50 ÷ 100
01410121		0,001	1	1,5	●	0,1	0 ÷ 50 ÷ 0

Permissible limits of a metrological characteristic (MPE/MPL)

		0,002 mm	0,001 mm
	Deviation span	10 µm	4 µm
	Deviation span within the local measuring span 0,10 mm	6 µm	4 µm
	Total deviation span	12 µm	5 µm
	Repeatability limit	1,5 µm	1 µm
	Max. hysteresis	2 µm	1 µm
	Measuring force	TOP Quality line	≤ 1,4 N
		TOP Quality line IP54	≤ 2 N

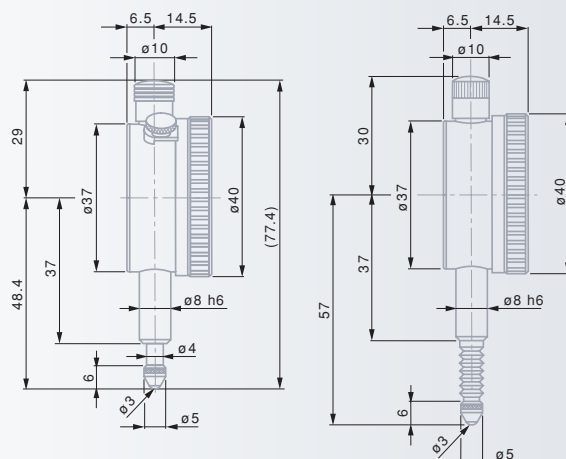

TESA YR and MERCER Dial Gauges – TOP Quality
57 or 58 mm dial diameter, 0,01 mm reading



EN ISO 463
Factory standard

0,01 mm

1,5 mm

Rotating dial.
Regular models with dial lock

Full-metal case housing.
Fixing shank and plunger in hardened stainless steel

High performance shock proof system in both directions

Adjustable tolerance markers
Measuring insert with a M2,5 thread.

3 mm dia. ball tip, already mounted

Cardboard box

Identification number

Inspection report with a declaration of conformity



TOP Quality line, with dial lock

01410610	0,01	10	10,5	●	1	0 ÷ 50 ÷ 100
01410611	0,01	10	10,5	●	1	0 ÷ 50 ÷ 0
01410612	0,01	10	10,5	●	1	0 ÷ 50 ÷ 100

TOP Quality line IP54 protected against the penetration of liquids, without dial lock

01410720	0,01	10	10,5	●	1	0 ÷ 50 ÷ 100
01410721	0,01	10	10,5	●	1	0 ÷ 50 ÷ 0

TOP Quality line with restricted reading range

01416029	250SRc-1TQ	0,01	±0,5	4	●	1	50 ÷ 0 ÷ 50
-----------------	-------------------	------	------	---	---	---	-------------

Permissible limits of a metrological characteristic (MPE/MPL)

	Deviation span	7 µm	15 µm		
	Deviation span within the local measuring span 0,10 mm	5 µm	8 µm		
	Total deviation span	9 µm	17 µm		
	Repeatability limit	3 µm	3 µm		
	Max. hysteresis	3 µm	3 µm		
	Measuring force	TOP Quality line	≤ 1,4 N	TOP Quality line IP54	≤ 2,2 N

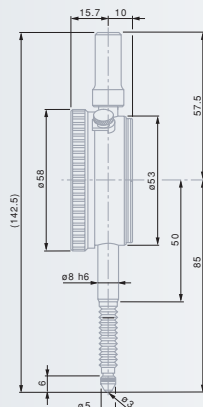
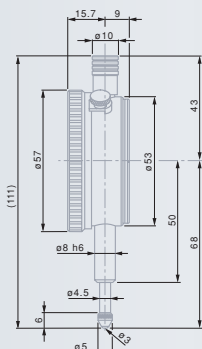

TESA YR and MERCER Dial Gauges – TOP Quality 57 or 58 mm dial diameter, 0,001 or 0,002 mm reading



- ✓
- EN ISO 463
Factory standard
- 0,001 mm
0,002 mm
- 1,5 mm
- Rotating dial.
Regular models with dial lock.
- Full-metal case housing.
Fixing shank and plunger in hardened stainless steel
- High performance shock proof system in both directions
- Adjustable tolerance markers
Measuring insert with M2,5 thread.
- 3 mm dia. ball tip, already mounted
- Cardboard box
- Identification number
- Inspection report with a declaration of conformity

<i>TOP Quality line, with dial lock</i>							
01410410		0,001	1	3,3	●	0,1	0 ÷ 50 ÷ 100
01410411		0,001	1	3,3	●	0,1	0 ÷ 50 ÷ 0
<i>TOP Quality line IP54 protected against the penetration of liquids, without dial lock</i>							
01410520		0,001	1	3,3	●	0,1	0 ÷ 50 ÷ 100
01410521		0,001	1	3,3	●	0,1	0 ÷ 50 ÷ 0
<i>TOP Quality line with restricted reading range</i>							
01416030	253SRc-1TQ	0,002	±0,08	3	●	0,16	8 ÷ 0 ÷ 8
01416028	SRc	0,001	±0,04	3	●	0,08	40 ÷ 0 ÷ 40

Permissible limits of a metrological characteristic (MPE/MPL)

Deviation span	2 µm	4 µm	1,5 µm
Deviation span within the local measuring span 0,10 mm	2 µm	4 µm	1,5 µm
Total deviation span	4 µm	5 µm	4 µm
Repeatability limit	1 µm	1 µm	1 µm
Max. hysteresis	1 µm	1 µm	1 µm
Measuring force	TOP Quality line ≤ 1,5 N	TOP Quality line IP54 ≤ 1,7 N	≤ 1,5 N

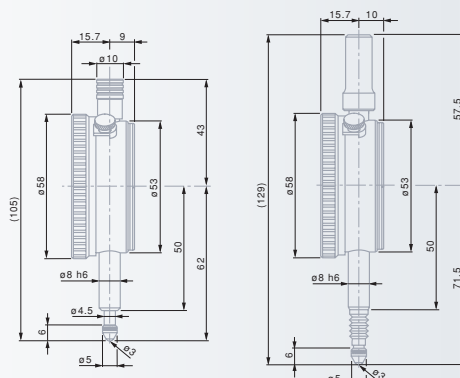

TESA YR and MERCER Dial Gauges – TOP Quality
82 mm dial diameter, 0,01 mm reading



EN ISO 463
Factory standard

0,01 mm

2,3 mm

Rotating dial, lockable.

Full-metal case housing. Fixing shank and plunger in hardened stainless steel

High performance shock proof system in both directions

Adjustable tolerance markers Measuring insert with M2,5 thread.

3 mm dia. ball tip, already mounted

Cardboard box

Identification number

Inspection report with a declaration of conformity

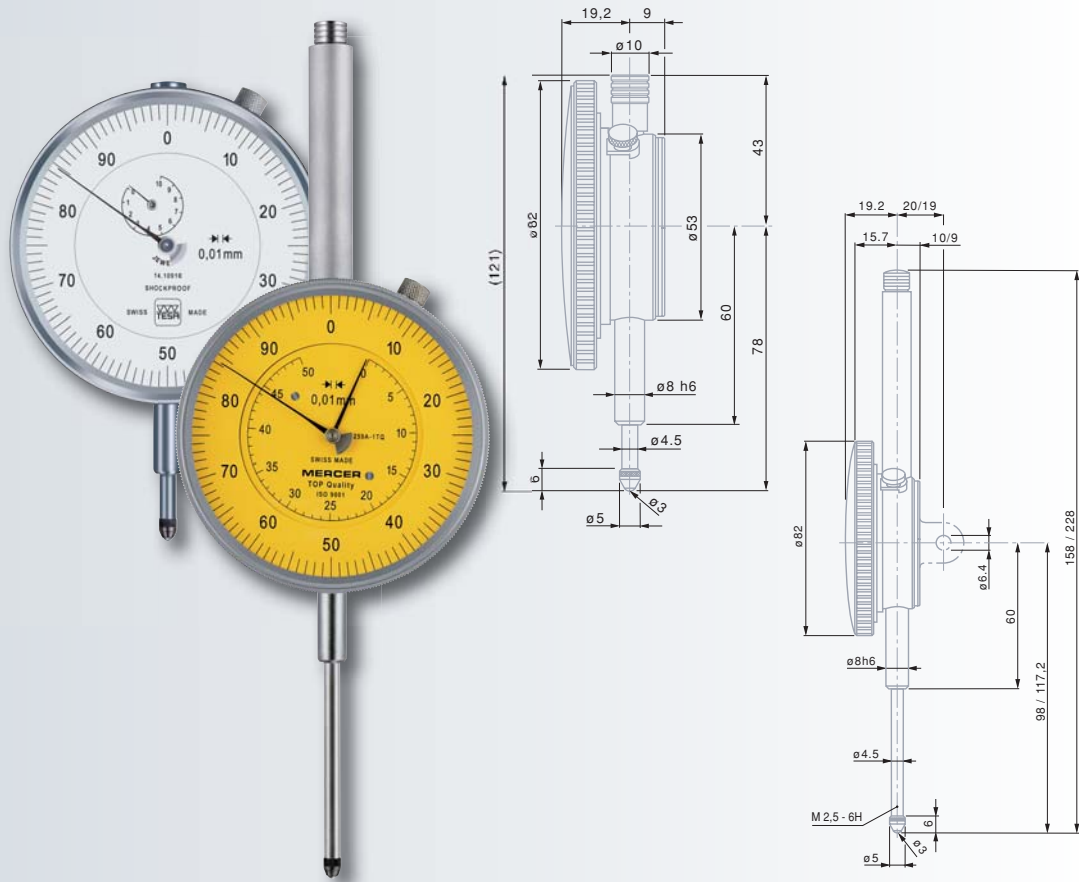

mm

mm

mm

mm

TOP Quality line, with dial lock

01410910		0,01	10	10,5	●	0,1	0 ÷ 50 ÷ 100
01410911		0,01	10	10,5	●	0,1	0 ÷ 50 ÷ 0

TOP Quality line with long range and dial lock

01416040	259-1TQ	0,01	30	30,5	●	0,1	0 ÷ 50 ÷ 100
01416041	259A-1TQ	0,01	50	50,5	●	0,1	0 ÷ 50 ÷ 100

Permissible limits of a metrological characteristic (MPE/MPL)

	10 mm	30 mm	50 mm
Deviation span	15 µm	20 µm	25 µm
Deviation span within the local measuring span 0,10 mm	8 µm	20 µm	25 µm
Total deviation span	17 µm	25 µm	30 µm
Repeatability limit	3 µm	3 µm	3 µm
Max. hysteresis	3 µm	5 µm	5 µm
Measuring force	≤ 1,4 N	≤ 2,2 N	≤ 2,5 N

TESA YR Dial Gauges – TOP Quality
82 mm dial diameter, 0,001 mm reading

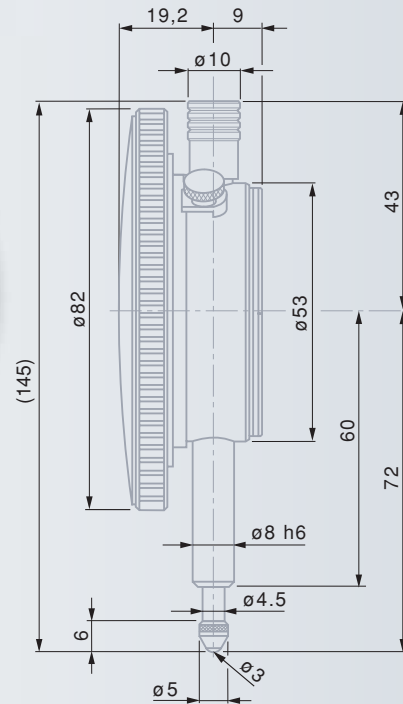

- ✓
- EN ISO 463
Factory standard
- 0,001 mm
- 2,3 mm
- Rotating dial,
lockable.
- Full-metal
case housing.
Fixing shank
and plunger in hardened
stainless steel
- High performance
shock proof system
in both directions
- Adjustable
tolerance markers
Measuring insert
with a M2,5 thread.
- 3 mm dia.
ball tip, already
mounted
- Cardboard box
- Identification
number
- Inspection report
with a declaration
of conformity

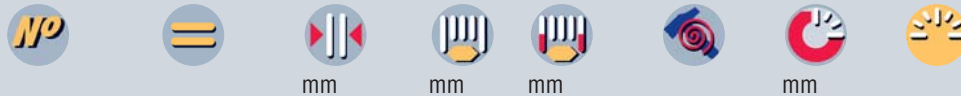

TOP Quality line, with dial lock

01410810	0,001	1	3,3	●	0,1	0 ÷ 50 ÷ 100
01410811	0,001	1	3,3	●	0,1	0 ÷ 50 ÷ 0

Permissible limits of a metrological characteristic (MPE/MPL)

		0,001 mm
	Deviation span	4 µm
	Deviation span within the local measuring span 0,10 mm	4 µm
	Total deviation span	5 µm
	Repeatability limit	1 µm
	Max. hysteresis	1 µm
	Measuring force	≤ 1,7 N